



Shop online, pick up locally.

Click & Collect pick-up station for more flexibility.

Stationary retailers who want to improve their reach are increasingly adding an online store to their sales channel. This multi-channel solution is becoming increasingly popular. But how can you flexibly hand over the goods to your customers who want to pick up the order?

With a Click & Collect pick-up station, these orders can be received flexibly in terms of time. The upside? Customers still come to their retail store. This improves customer loyalty much more than an "anonymous" postal delivery or hassle with opening hours. You also benefit from this, orders no longer have to be packed, labeled and taken to the post office.



The advantages of a Click & Collect pick-up station.



Available 24/7

Customers can pick up or return goods at any time, even on weekends.



Little effort, easy to integrate

Store goods easily with just a few clicks or integrate them into existing store systems.



Satisfied customers, more sales

Easy combination of on and offline, high customer service and frequency in front of the store.

This is how the storage process works:

1. Your customers order goods by phone or via webshop and select pickup as a delivery option.
2. Your employee:in deposits the desired items in the locker.
3. The recipient will receive a notification via SMS/email.
4. Collection by the authorized person(s), notification that the goods have been collected.

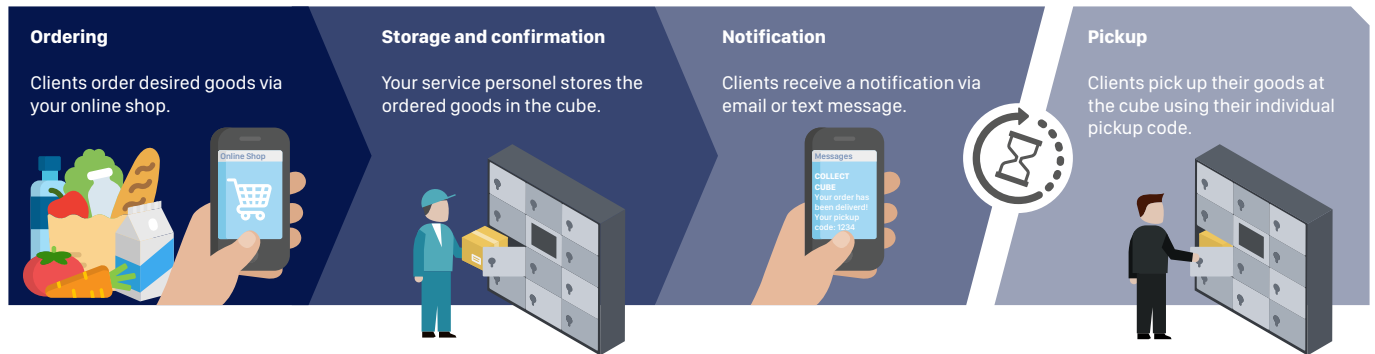

Easy handling with Click & Collect solutions from Variocube.



Intuitive software and suitable for outdoor use.

Our intuitive software makes it easy to manage orders without extra effort or tedious trips to the post office. Our pick-up stations are weather-protected, so they can also be set up outdoors without hesitation.



Easy pickup 24/7

Your customers will receive an email with an access code or QR code after placing the order. The order is then picked up using this code. Completely independent of opening hours, your customers can pick up orders at any time.



Solutions for shopping streets.

Expand the offer of your boulevard together with your neighbors, with a pick-up station you can increase the frequency of your boulevard. As an additional added value, there is the possibility to open the facility for parcel reception as well. This way you can also attract new visitors and thus increase their reach.

